

Linwood Avenue Unit 2, 218 Linwood Avenue



Situated on the corner of Linwood Avenue and Cashel Street is this affordable retail/office space.

It includes a common apportionment with excellent shared facilities and 12m² storage area on level one. The space is well decorated and has the benefit of air-con, burglar alarm, fire system and surveillance cameras.

Adjacent to this building is the Eastgate Shopping Mall and Burger King.

**Enquire today
021 899 623**

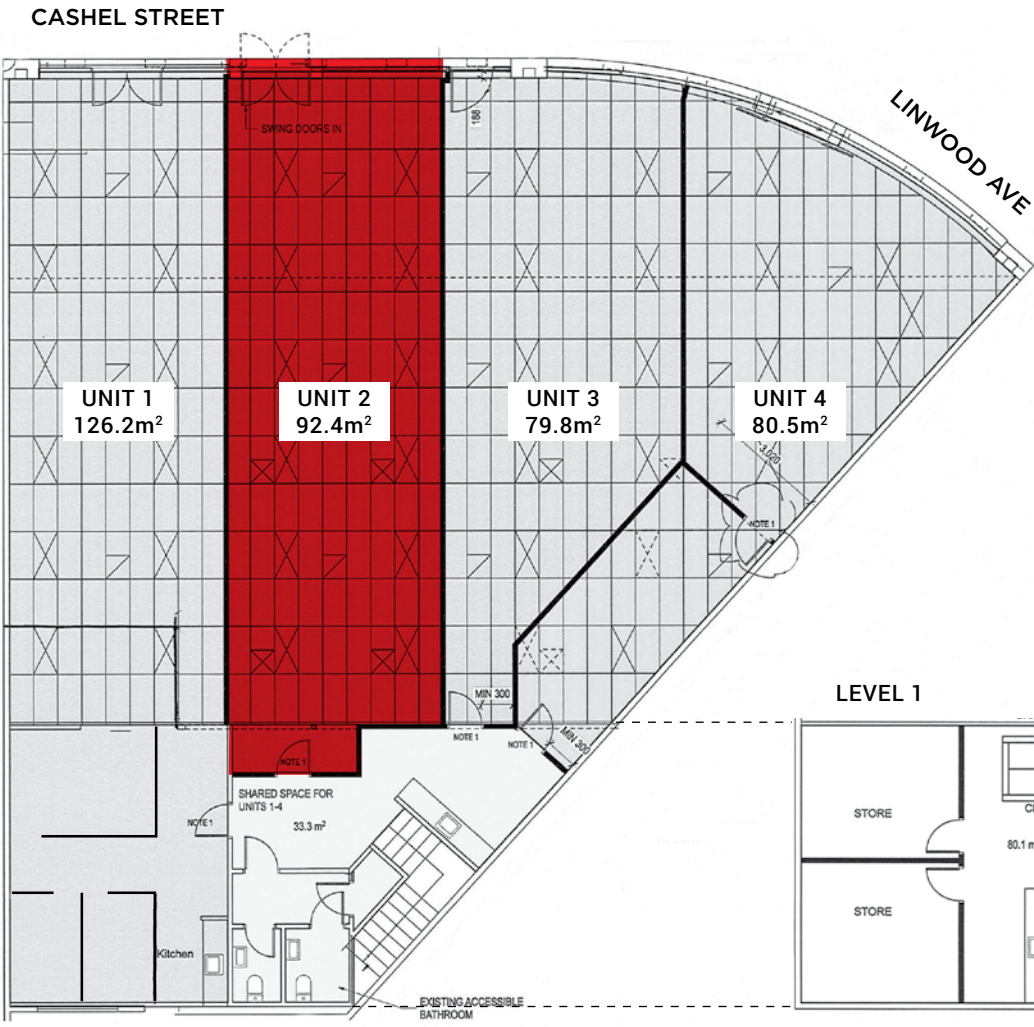

Linwood Avenue

218 Linwood Avenue

Area M²

100.41 incl. common share

Rental Net P.A. + GST

\$20,082.00

Opex incl. Rates Net P.A. + GST

Approx. \$7974.84

Enquiries: Shaun Stockman 03 977 4986 021 899 623 shaun@kpiStockman.co.nz