

---

# W. L. Brown and Co.

---

36 Southwark Street, Christchurch    **Built 1953**



above  
your space





# Our Focus

To build spaces for people, with a focus on supporting the thriving small business community in Christchurch. It's about re-purposing what little is left of the great history of Christchurch.

Browns Engineering was a family business created in the 1950's. The Browns built these buildings to house their foundry and engineering business and it was a thriving part of Christchurch for decades.

We create unique spaces from interesting buildings.



**“The purpose — where I start — is the idea of use.  
It is not recycling, it's reuse.”**

**ISSEY MIYAKE**





# Space for people, space for business



All brochure office imagery shown are for illustration purpose only.



# Community





# Christchurch's SALT District

W. L. Brown and Co. is located at the eastern end of the Christchurch South Frame/Pūtahi Whakatetonga in the SALT District, an area of authentic laneways, unique character, history and people.

36 Southwark Street is not much more than a stone's throw away from ARA and the significant Vodafone/Kathmandu sites.

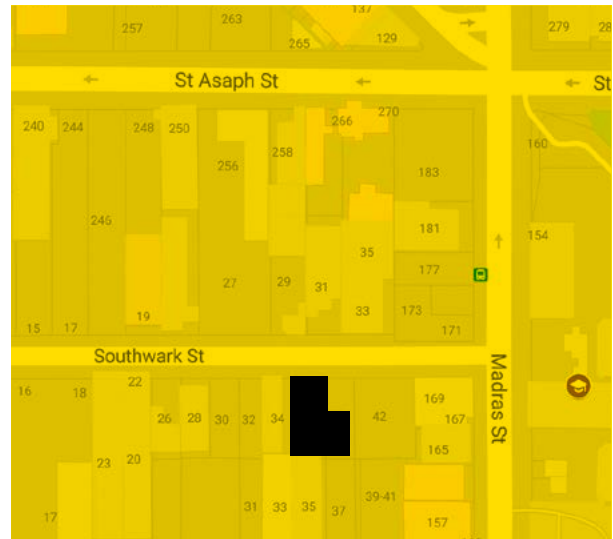
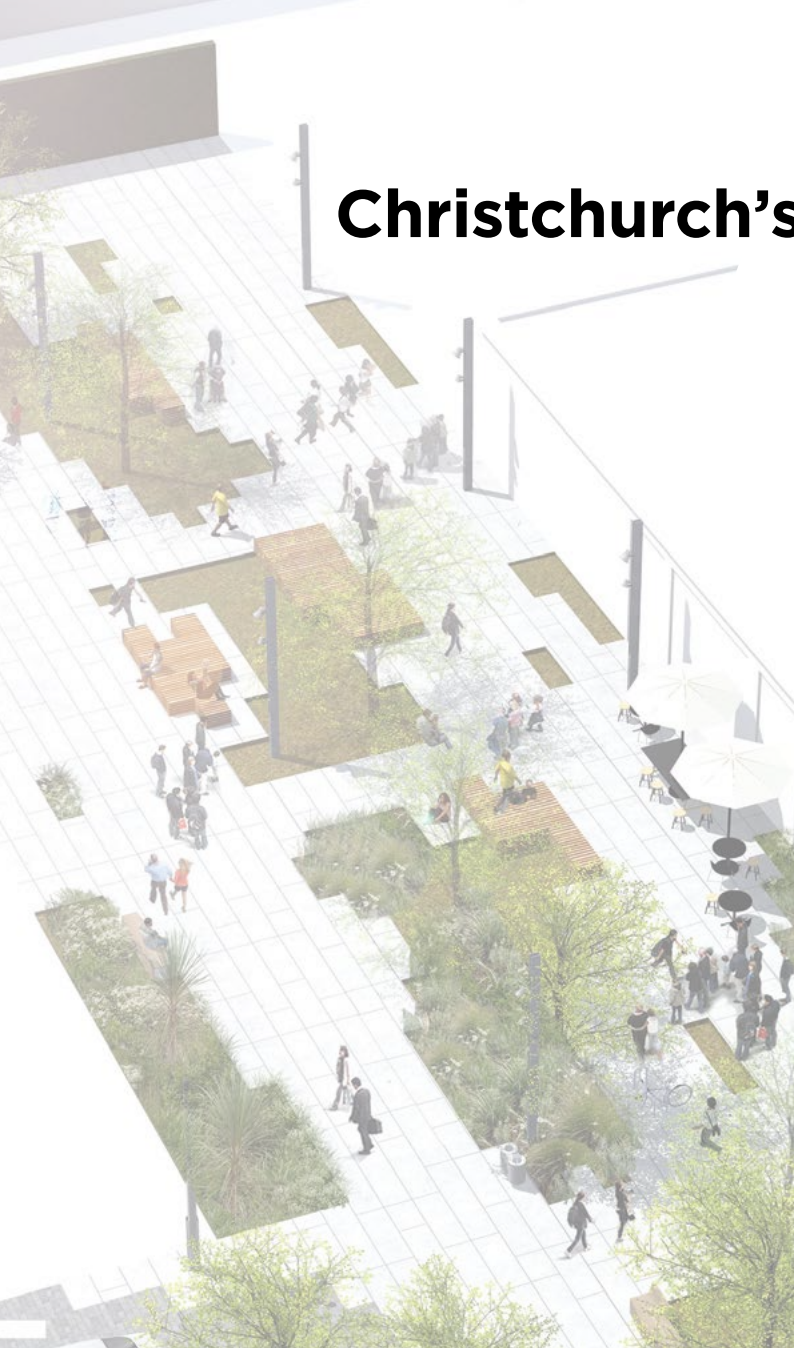

**W. L. Brown and Co.**  
36 Southwark Street, Christchurch

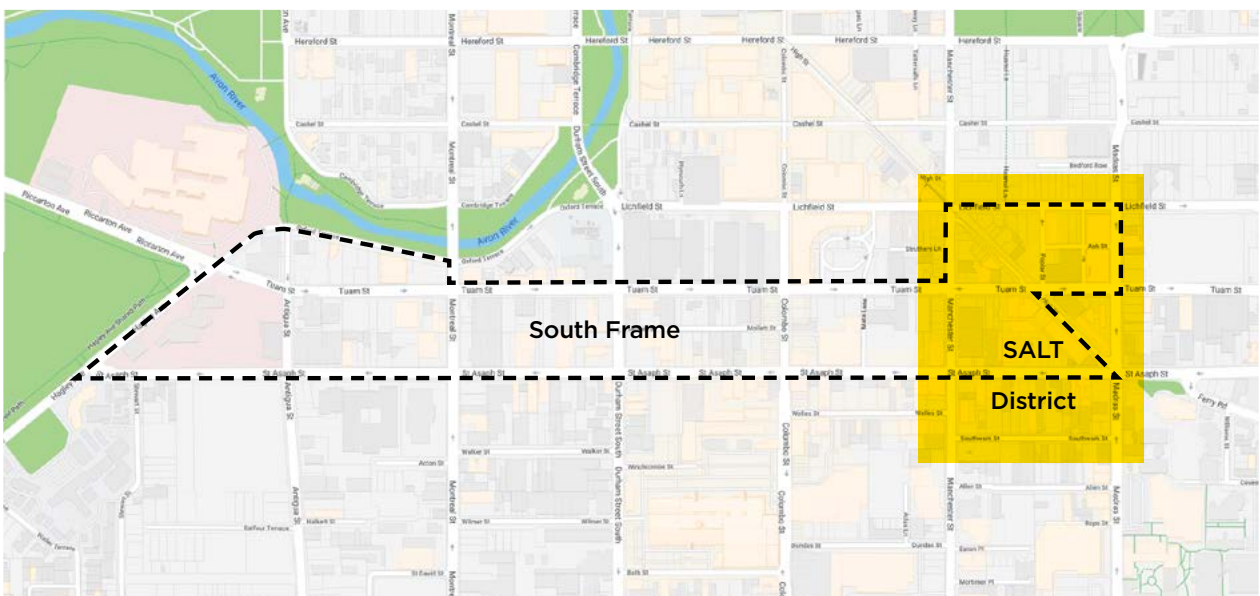



SALT District brings together the adjacent St Asaph, Lichfield and Tuam Street blocks, blending across High Street, extending from Stranges Lane to Southwark Streets.

SALT District is set apart by character and liveliness; an alternative to the glossier CBD and retail precinct. It will be more than a thoroughfare. It will be a destination for central city events or markets, a place to gather, dine, be entertained or just relax.

By late 2018, SALT District will be a dynamic office, hospitality and retail district. The completion of the Vodafone, Kathmandu and High Street Lanes and McKenzie & Willis developments with a combined staff of approximately 1850 office workers along with the established iconic C1 Espresso, Dux Central and The Little High Eatery will inject life and energy into this part of the city.

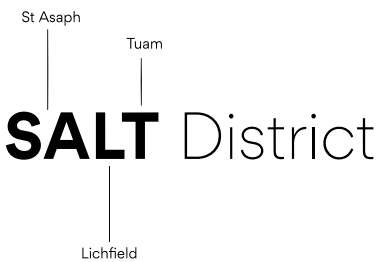

Clockwise from top left: Little High Eatery, Dux Central, Lichfield Lane, C1 Espresso at The Old Post Office, Uncommon, Dux Central and Vodafone.



# Ground Floor

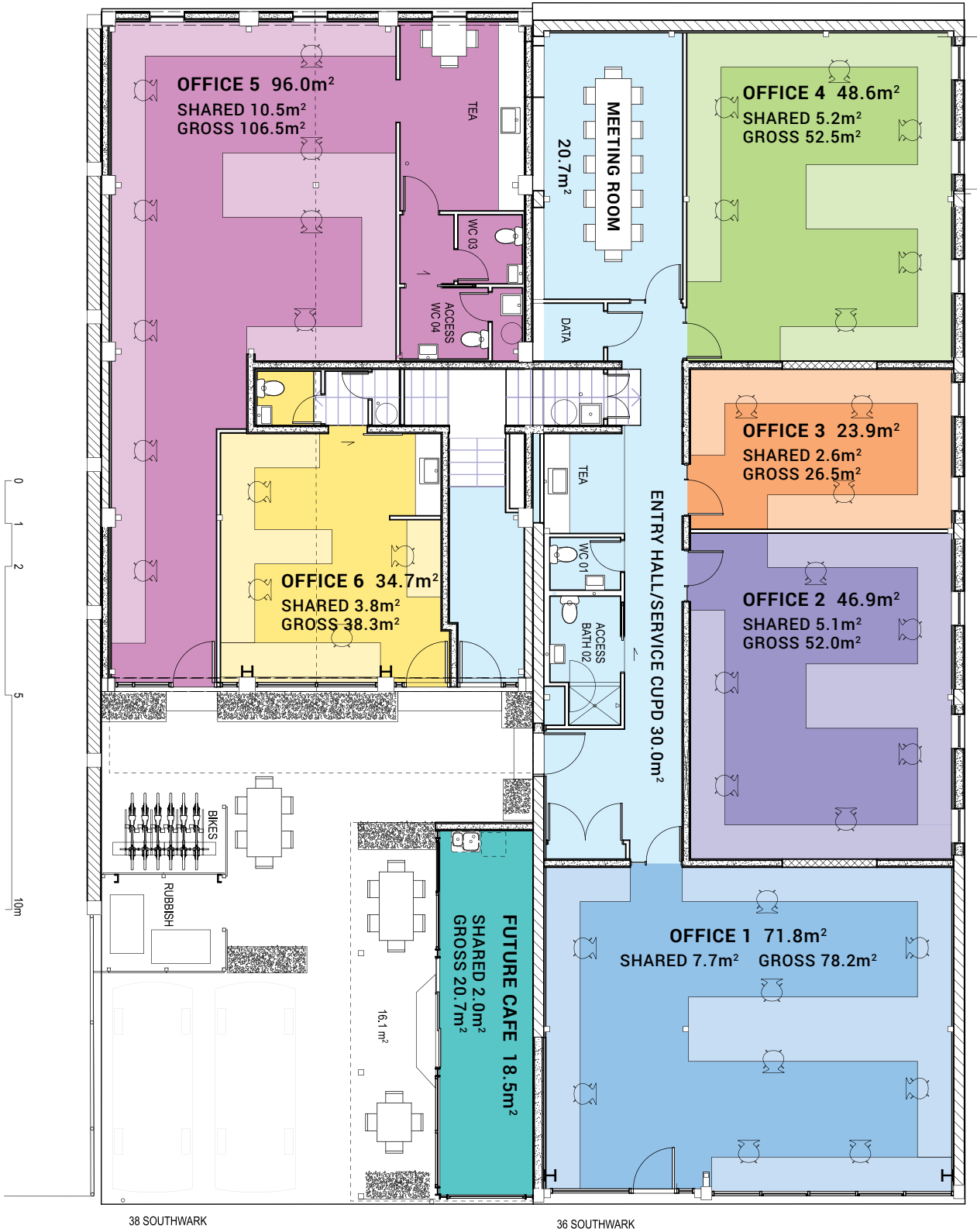



# First Floor

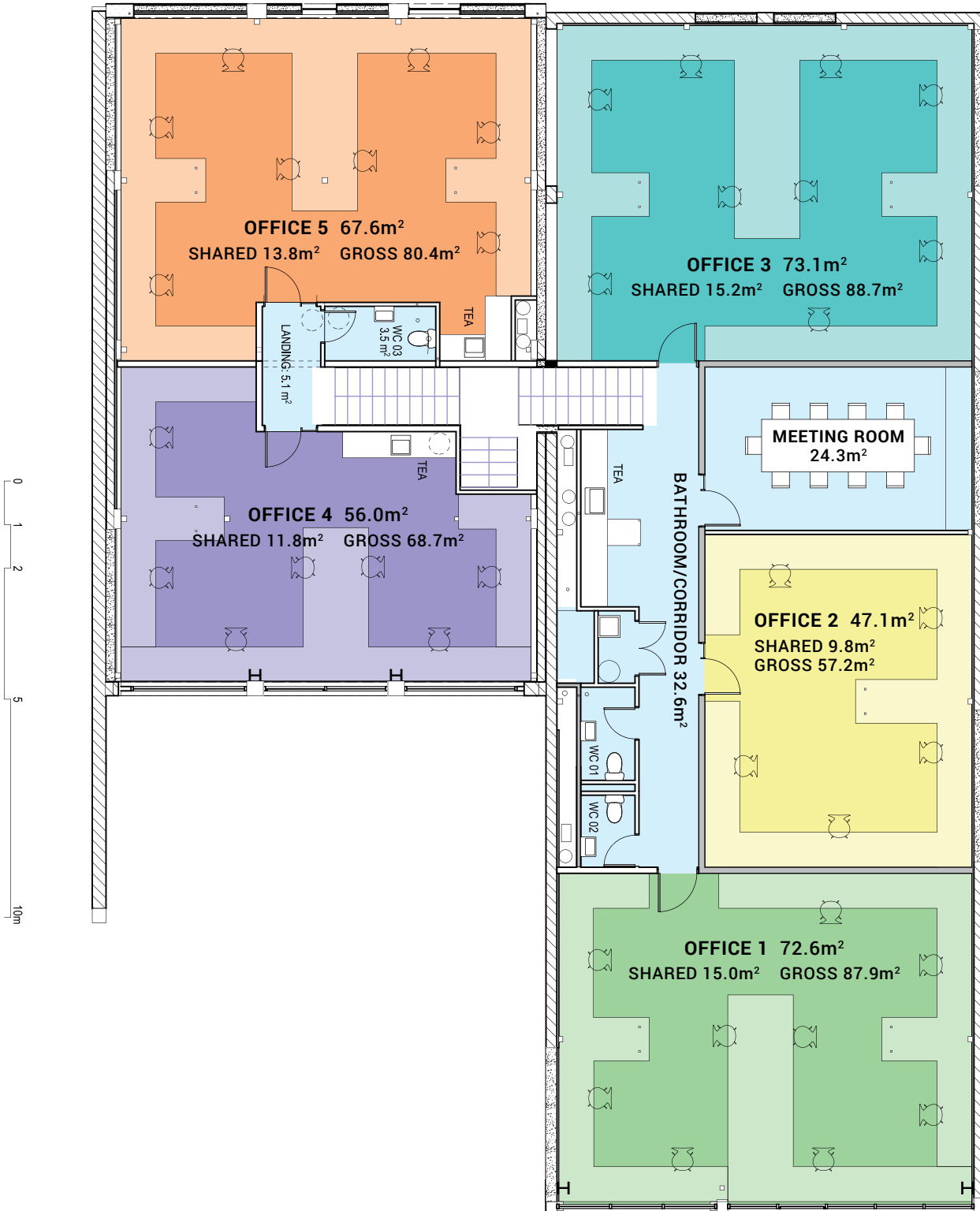







**Your place to work, collaborate  
and grow your business**



**above**  
your space

[aboveyourspace.co.nz](http://aboveyourspace.co.nz)